

Setup of ventilation devices and controls using the app

General note: A maximum of 12 participants (e. g. 11 fans and 1 control unit) can be integrated into a mesh network.

1

Install the **getAir SmartControl App** on your smartphone and launch it. Select „**Setup**“ and then „**Set up a wireless system**“. **Allow the use of Bluetooth** in the appearing prompt. Then, go to „**Set up comfort system**“ and „**Start adding devices**“. Follow the instructions in the app.



getAir App

2

Take **your smartphone to a ventilation unit**. Remove the cover of the inner frame and open the cover of the board on the bottom left. **Press and hold** the clearly visible **black button** until the **LED lights up blue once**. If the **LED lights up green and then blinks white**, the fan has been successfully connected and **will also appear in the app**.
If the device's LED lights up red, a connection could not be established. Try again by repeating this step.

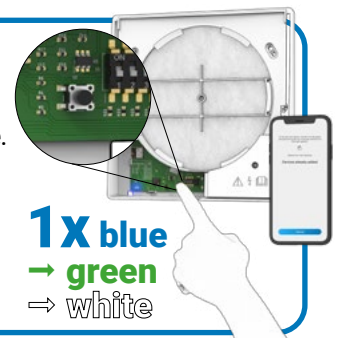

1x blue
→ green
⇒ white

3

Now, go one by one to the **remaining ventilation units** and follow the **instructions from step 2** to include them in the mesh network as well.

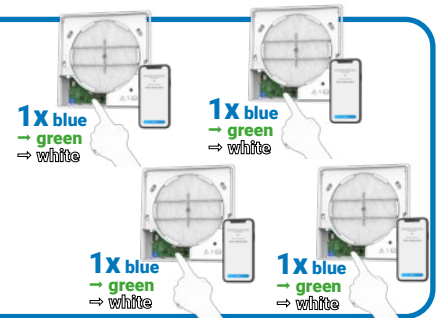

1x blue
→ green
⇒ white

1x blue
→ green
⇒ white

1x blue
→ green
⇒ white

1x blue
→ green
⇒ white

4

Once you have integrated all ventilation units into the mesh, go to the control unit. **Press and hold the grey fan icon** until the **LED lights up blue once**. If the **LED lights up green and then blinks white**, the control unit has been successfully connected and **will also appear in the app**.
If the LED lights up red, a connection could not be established. Try again by repeating this step.



1x blue
→ green
⇒ white

5

Once **all ventilation units and controls are connected** and displayed in the app, select „**Done**“ in the app. The setup is now completed, and the data is distributed to all connected participants (fans and controls).

*All information regarding the **WiFi setup of the ComfortControl Pro BT control unit** can be found in its **installation and operating manual** from page 33.*



Manual