

Setup of ventilation devices and controls without the app

General note: A maximum of 12 participants (e. g. 11 fans and 1 control unit) can be integrated into a wireless system.

1

Go to a ventilation unit. Remove the cover of the inner frame and open the cover of the board on the bottom left.

Press and hold the clearly visible **black button** until the **LED lights up blue two times**. If the **LED then blinks blue**, proceed to the nearest fan.

! Remember the first ventilation unit. You need to return to it at the end to complete the setup.

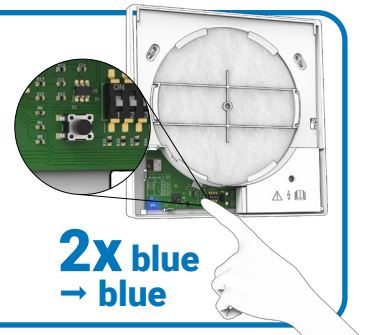

2

For the next ventilation unit, **press and hold the black button** until the **LED lights up blue once**. If the **LED lights up green and then blinks white**, the fan has been successfully connected.

If the device's LED lights up red, a connection could not be established. Try again by repeating this step.

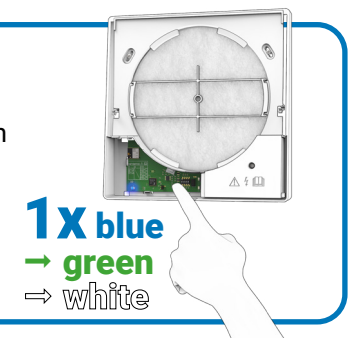

3

Now, go one by one to the **remaining ventilation units** and follow the **instructions from step 2** to include them in the wireless system as well.

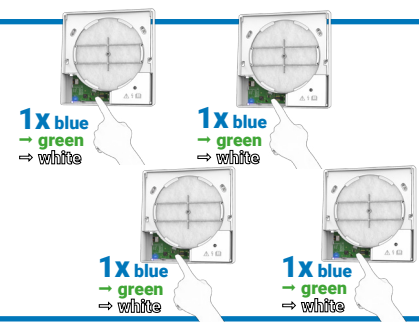

4

Once you have integrated all ventilation units into the wireless system, go to the control unit. **Press and hold the button**  until the **LED lights up blue once**. If the **LED lights up green**, the control unit has been successfully connected.

If the LED lights up red, a connection could not be established. Try again by repeating this step.

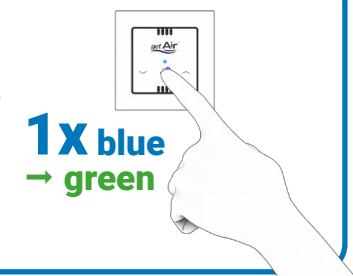

5

Once all ventilation units and controls are connected, **go back to the first ventilation unit**. **Press and hold the black button again** until the **LED lights up blue once**. The setup is now completed, and the data is distributed to all connected participants (fans and controls).

